



DMTD WATKINS GLEN EVENT INFORMATION: JUNE 2-3, 2025

ALL INFORMATION SUBJECT TO CHANGE WITHOUT NOTICE

PLEASE SHARE THIS INFORMATION WITH ALL DRIVERS, CREW MEMBERS, TRUCK DRIVERS AND TEAM MANAGERS

LOAD IN PARKING: Sunday, June 1, starting at 6pm. Monitor channel 40 CB radio for directions.

ALL INFORMATION SUBJECT TO CHANGE WITHOUT NOTICE

COMMUNICATION: Download the “WhatsApp” if you would like to receive message updates during the event, starting Sunday. After downloading, click this link to join this event group:

<https://chat.whatsapp.com/KUwQtFjFEEa0GNIMU8mVmk>

Paddock Access/Garages: To ensure multi-car teams are not separated, we are assigning garages and organizing parking for June 1.

The paddock will be open to DMTD participants on Sunday, June 1 starting at 6pm and garages will be closed at 9pm each night. All transporters will be staged at the WGI Registration Building (top of the hill by Gate 4A). Transporter drivers will sign the track waiver and be issued a track wristband. **Rigs only, no cars**, will leave the registration area in small groups (to avoid stopping on public roads) and proceed through Gate 2 to the garage area to park. Rigs will enter the garage area on the end where “The Little Speed Shop” is (see attached map). We will have 2 lanes as we enter the Garage area and begin with Garage 1 ending with Garage 14 in the left lane, Garage 30 ending with Garage 17 in the right lane. See the attached map, to follow for order of team parking load in. The garages will close at 9pm each night.

NOTE: Passenger cars, support trucks, etc. will be allowed access through Gate 2 Security only after all rigs are parked.

PIT LANE: Will be open for teams wishing to set up equipment from load-in on Sunday evening.

IF YOUR RIG IS NOT READY TO LOAD IN ON TIME YOU MAY NOT BE ABLE TO PARK NEAR YOUR GARAGE.

REGISTRATION: Will be held in the Classroom, Great Room on the second floor of the Media Center, on Monday morning from 7:15am and will close **promptly** at 7:55am. You will be required to sign our Release and Waiver of Liability and Indemnity Agreement and will then be issued an event windshield sticker and a driver wristband. NOTE: wristbands will not be issued to any unregistered drivers. After the drivers meeting registration will move to room on the northwest side of the garages (closest to pit lane).

DRIVER MEETING: There will be a **MANDATORY DRIVER MEETING** following registration in the Classroom, Great Room on Monday at 8:00am.

HOURS: **Monday** the track will be hot from 8:30am to 4:30pm, **Tuesday the track will be hot 8am-4pm**, with a break for lunch from 12:00pm to 1:00pm each day. (The early schedule Tuesday is to help with flights out and load in of our next event.

RENTAL CAR LAPS: Monday, June 2, 5:30-6:30pm

GARAGE AREA PROTOCOL: No fueling or storage of fuel is permitted in the garages. Direction of travel around the garage is counter-clockwise only. This applies to all vehicles including pit bikes, tugs, street cars, etc. There is no smoking in the garages.

TIRE SERVICE: will be provided by Jackson Motorsports during the event. For more information and to order tires, contact Evan Weintraub at evan.weintraub@jacksonmg.com. Evan can also be reached at (843) 271-1330.

LUNCH: We are providing hot lunches for all participants and crew for both days of our event. Service will be available in the Jack Daniel's Club from 11:30am until 1:30pm.

FUEL: Sunoco fuel, both leaded and unleaded, will be available each day from 8:30am until 3:30pm.



Link to order fuel delivered to track is on our website home page under "Track Days" menu.

REMOVE ALL EMPTY FUEL DRUMS FROM TRACK WHEN THE EVENT ENDS

LODGING: Radison Corning [Car Clubs at Watkins Glen International - Special Discounted Room Rates Link!](#) Special needs contact Emily Walter, O: 607.962.5000, C: 312.668.8959, ewalter@corehotelsandresorts.com

TRACK DAMAGE: Drivers/teams are financially responsible for any damage that they cause to race track property including, but not limited to, tire bundles, guard rails and posts. Additionally, any absorbent material used to clean up after fluid spills, leaks, etc. and/or any fire suppression used on your

behalf will be billed back to the driver/team responsible. WGI has informed us that, if a comprehensive cleanup is necessary due to a significant fluid spill, the charge will be \$500 per hour.

GARAGE/PADDOCK Assignments Map:

Load in hauler traffic flow

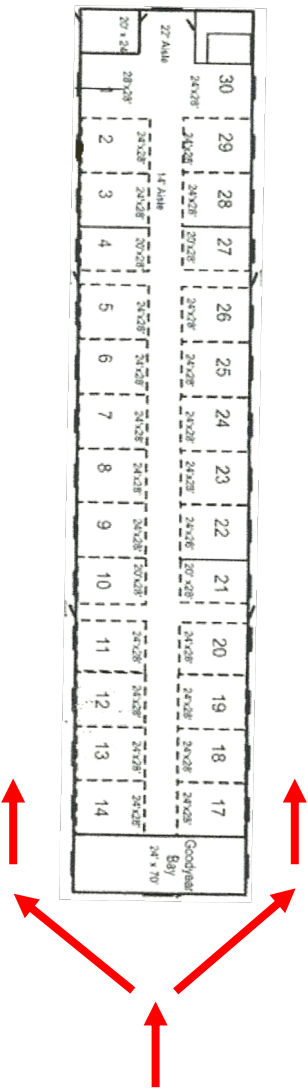

Assignments (Also Load In Order)

Left Side of Garages		Right Side of Garages	
Garage	Team	Garage	Team
1	HEART OF RACING	26-30	JTR
2-5	TRUSPEED	25	KELLY MOSS
6-8	EXTREME VELOCITY	22-24	FLYING LIZARD
9-10	ONE	21	LONE STAR
11	GMG	20	WRIGHT
12-13	BGB	18-19	HAIRY DOG
14	CPT	17	JACKSON

Paddock (Check Map)

Garage	Team	Garage	Team
PADDOCK	TR3	PADDOCK	VASSER SULLIVAN / TRD
PADDOCK	LAGASSE	PADDOCK	PRATT MILLER
PADDOCK	DAS	PADDOCK	MULTIMATIC

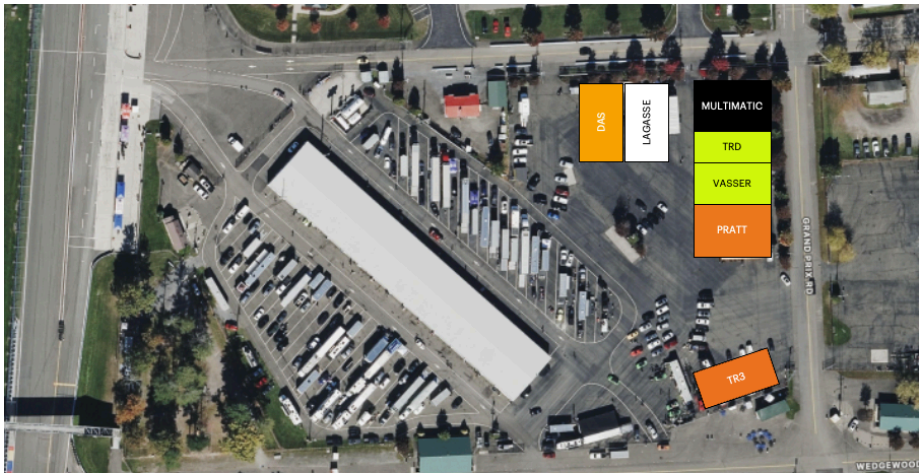

Only the BLUE areas are designated to DMTD parking.

